

JOIN US AT

WINDPOWER 2011!

Take advantage of the world's leading wind energy conference!



AWEA WINDPOWER 2011

CONFERENCE & EXHIBITION
ANAHEIM, CA May 22-25

Registration deadline:
March 2, 2011

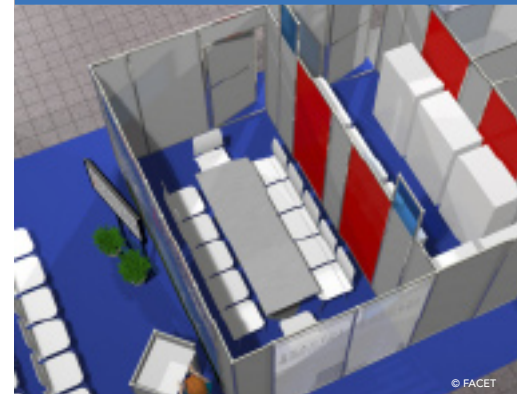
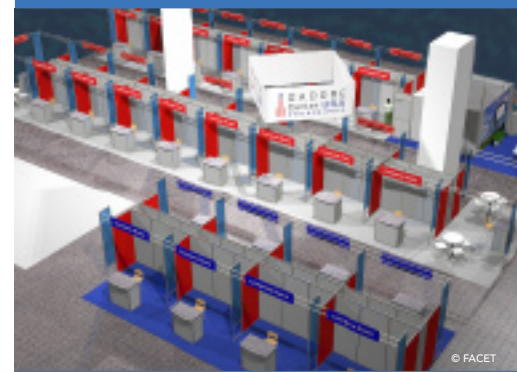
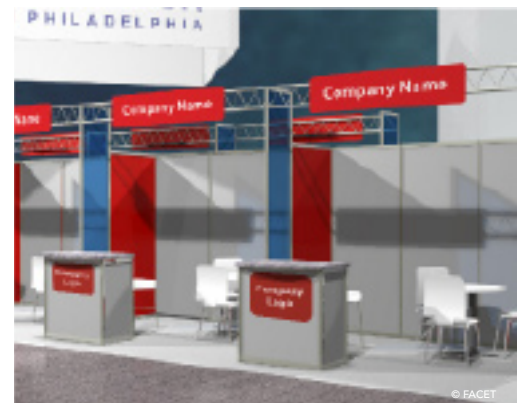
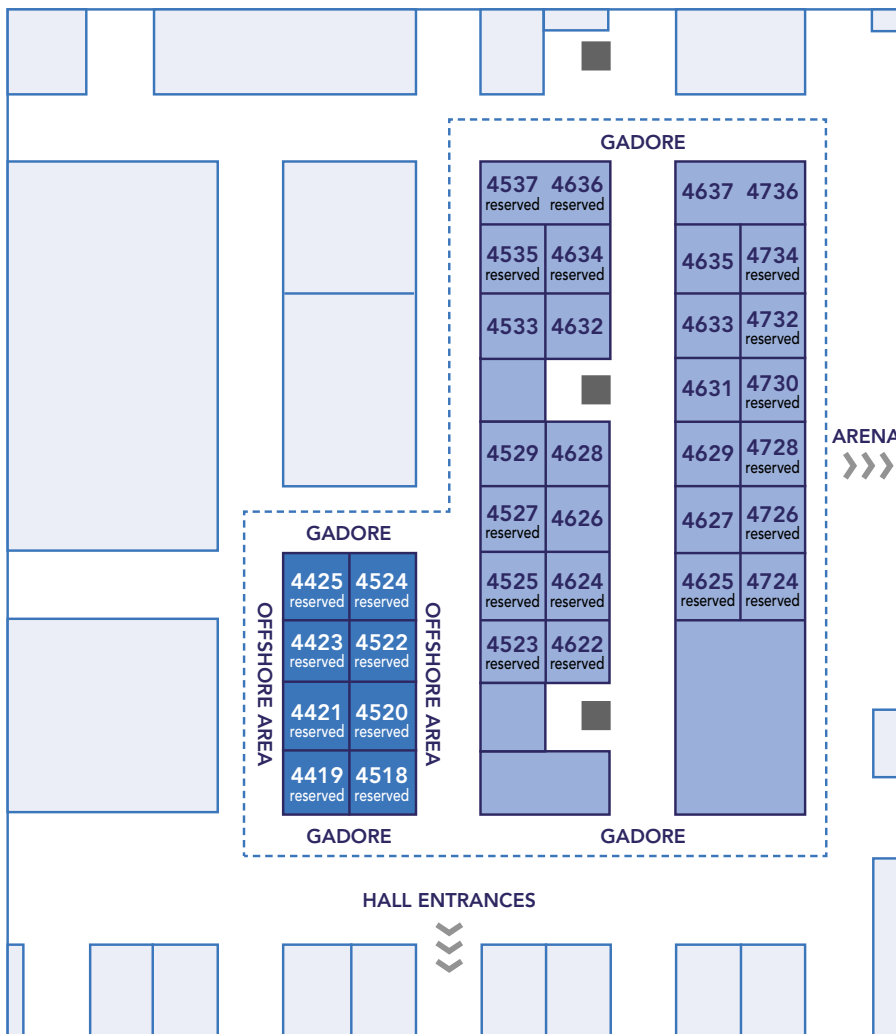

JOIN US AT WINDPOWER 2011 CONFERENCE AND EXHIBITION, THE WORLD'S LARGEST ANNUAL WIND POWER CONFERENCE!

Our knowledgeable German-American team is focussed solely on your long-term success in the United States.

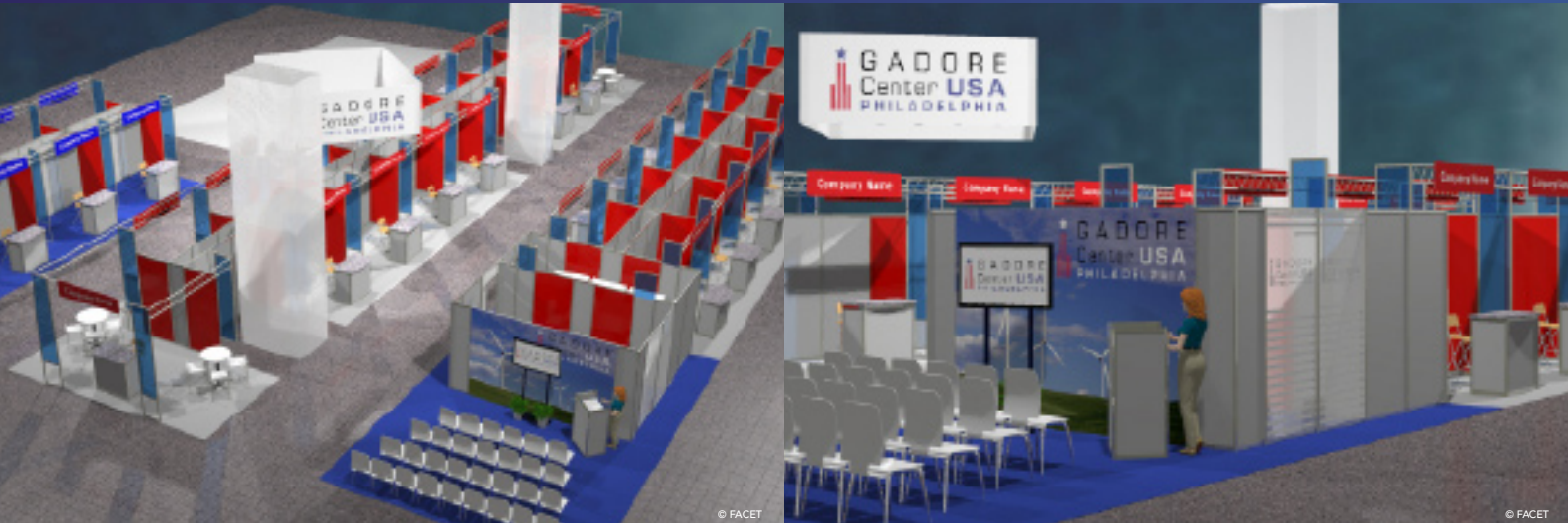

GADORE INTERNATIONAL PAVILION- EXHIBITOR INFORMATION

(incl. discounted AWEA membership rates and support from our knowledgeable GADORE team)

1. WE INVITE THE FOLLOWING COMPANIES TO JOIN US AS EXHIBITORS AT THE GADORE INTERNATIONAL PAVILION:

1. Companies that are already AWEA members.
2. Companies that are not AWEA members yet. These companies must become AWEA members. We will mail the AWEA membership application form to you. As a GADORE International Pavilion exhibitor, you will be offered a special, discounted AWEA membership fee: 1100 USD for the first year.

2. FLOOR PLAN:

Please indicate your preferred booth number. While we will try to accommodate your preferred location, all booth assignments will be made by GADORE based upon the order they are received and the best interest of the overall exhibit area.

3. INVOICING/PAYMENT:

You will be invoiced directly by AWEA. A 50% deposit is due at registration. Additional GADORE fees will be invoiced separately.

4. REGISTRATION DEADLINE:

The deadline to reserve a booth within the GADORE International Pavilion is March 2, 2011. Booths will be allocated on a first-come, first-served basis. We will offer a dedicated offshore area for offshore companies. This area is located within the GADORE International Pavilion and will stand out from the other booths due to a different color scheme.

5. CO-EXHIBITORS:

Exhibitors are entitled to accommodate one (1) co-exhibitor within their booth. Both companies will be listed on the exhibition floor plan and in the conference directory. Please provide name and contact information of your co-exhibitor. **Payment:** One exhibitor will be charged the full AWEA fee, the second exhibitor only pays 50% of the fees of an AWEA member.

SERVICES AND FEES

6. FEES

6.1. AWEA SERVICES AND FEES:

You will be invoiced by AWEA for the following:

Booth:

The AWEA booth fee is US\$ 31/sq ft for new AWEA members, US\$ 33/sq for corporate AWEA members, and US\$ 36/sq ft for associated members.

Membership Fee:

US\$ 1100 for new members. US\$ 1200 for associated members, US\$ 1700 for corporate members.

6.2. GADORE SERVICES AND FEES:

You will be invoiced by GADORE for the following:

GADGORE Exhibitor Support Package:

1,200.00 EUR plus VAT per person/company (includes exhibitor pass)

GADORE Services:

- › Pavilion management/on-site support
- › **2 press conferences** within the GADORE Pavilion (**onshore and offshore**)
- › **Integration in the AWEA event presentation program** (onshore and offshore), depending on availability of speaker slots
- › **Continuous, self-running presentations** (incl. movies) of all exhibitors and co-exhibitors on a large monitor in the GADORE Pavilion common area
- › **Live presentations** in the GADORE Pavilion common area (1 presentation slot per company, 5-10 minutes per presentation). GADORE will provide the necessary technical setup.
- › **CD** with all GADORE exhibitor presentations
- › Extensive **US public relations campaign** in 2011
- › **Announcements on www.gadorecenter.de and www.gadorecenter.com in 2011**
- › Preparation for **4th European-American Matchmaking**

6.3. GADORE BOOTH CONFIGURATION/FURNISHINGS

(for 10x10 sq ft Booth): A 10x10 booth includes:

- › Octanorm® Exhibition System – red and grey aluminium frame with 3 mm PVC filling
- › Light blue plexiglass
- › Locking reception counter with **company logo** and 1 bar stool
- › Table with chairs
- › Company logo
- › 2 sets of light boxes (3 bulbs each)
- › Grey carpet tiles (for 10x10 booth area)

6.4. GADORE BOOTH RENTAL FEES FOR 10X10 SQ FT BOOTH (approx. 9.5 sq m)

These fees will be charged in addition to the standard AWEA booth rental fee.

Please multiply fees in case of a larger booth size:

5000 USD (current conversion rate: 0.73541 EUR)

The above fee also includes:

- › **Drayage/Material handling** (for standard booth equipment/furniture only, not company specific displays/equipment etc.)
- › **Electricity** (calculated based on data from the Anaheim Convention Center)

7. PASSES:

2 booth personnel passes per 100 sq ft booth. Booth personnel passes include all exhibit hall receptions, coffee breaks each morning, lunches served in the exhibition area, afternoon beverage breaks and special networking events. 200 square foot booths are entitled to two free booth personnel passes and one full conference pass. We recommend that you attend the conference and are happy to advise you re. event selection and networking opportunities. For further information, go to <http://www.windpowerexpo.org/>

8. GADORE CONFERENCE TEAM:

Contact: GADORE Center Germany: Annette Nüsslein, info@gadorecenter.de

Contact: GADORE Center USA: Barbara Gaspard, barbara_gaspard@gadorecenter.com

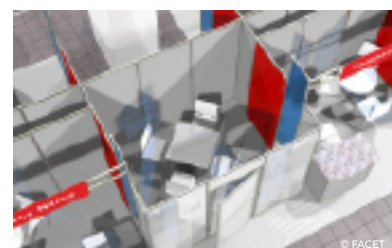

REGISTRATION

**Registration deadline:
March 2, 2011**

› 1. PRIMARY EXHIBITOR

1. PRIMARY EXHIBITOR / Company Name: _____		Number of WINDPOWER Attendees: _____	
Address: _____		City/ZIP: _____	
State: _____		Responsible Person: _____	
Telephone#: _____	Fax#: _____	Email: _____	Web: _____
Date: _____		Signature: _____	

› 2. CO-EXHIBITOR

2. CO-EXHIBITOR / Company Name: _____		Number of WINDPOWER Attendees: _____	
Address: _____		City/ZIP: _____	
State: _____		Responsible Person: _____	
Telephone#: _____	Fax: _____	Email: _____	Web: _____
Date: _____		Signature: _____	

a) Offshore: Onshore: b) Requested Booth Number: _____

Please note: While we will try to accommodate your preference re. booth location, all booth assignments will be made by GADORE based upon the order they are received and the best interest of the overall exhibit area.

3. REGISTRATION AND PAYMENT:

This registration form is binding and will be forwarded to the American Wind Energy Association (AWEA). According to AWEA Exhibitor Rules and Regulations, booth rental fees are payable to AWEA, except for GADORE services that are part of the GADORE Pavillion. GADORE will invoice you directly for those services, after we have received your registration form.

4. REFUND FOR CANCELLATION:

Should the exhibitor be unable to occupy and use the exhibit space contracted, the exhibitor shall promptly notify GADORE in writing. Notification must be received within 7 days of receipt of the original registration.

Please fax your registration form back to: Fax-Nr.: +49 (0) 211 / 56695-105 or 215-386-3970

GADORE Center USA LLC
c/o windConsultant – Annette Nüsslein
Annette Nüsslein, Wiesdorfer Strasse 5
40591 Düsseldorf, Germany
Tel: +49 (0) 211 / 56695 -104 • Fax: +49 (0) 211 / 56695 -105
Mobil: +49 (0) 175 / 4 73 33 63
Email: info@gadorecenter.de • Web: www.gadorecenter.de

GADORE Center USA LLC
Barbara Gaspard – Center Manager
Phone: 215-966-6011
Fax: 215-386-3970
Cell: 610-233-5130
Mail: info@gadorecenter.com
Web: www.gadorecenter.com